



Study abroad at Paris School of Business!

Where business
meets creativity.



1. School presentation
2. Studying in Paris
3. Our Study Abroad programs
4. Short Programs

01

School presentation

Paris School of Business in numbers

1974

Creation of Paris School of Business

18 846

Alumni

2 262

Study/work program students in 2023

+4000

Students

3000

Company partnerships

+100

Teacher-researcher

+150

Foreign university partnerships

+100

Nationalities on campus

Triple accreditation



Association of Masters of
Business Administration



European Foundation
for Management Development



Association to Advance
Collegiate Schools of Business

Rankings

Le Point

PGE program ranked

3rd

in post high school programs
(February 2023)

Le Figaro Étudiant

TOP

5

best Business School in
France
(November 2022)

Challenges

6th

in post high school programs
(February 2023)

Le Parisien Étudiant

12th

post high school
Bachelor
(March 2023)

International Mobility

156

University partners



50

Countries

18

Universities with a triple accreditation

20

Universities with a double degree agreement

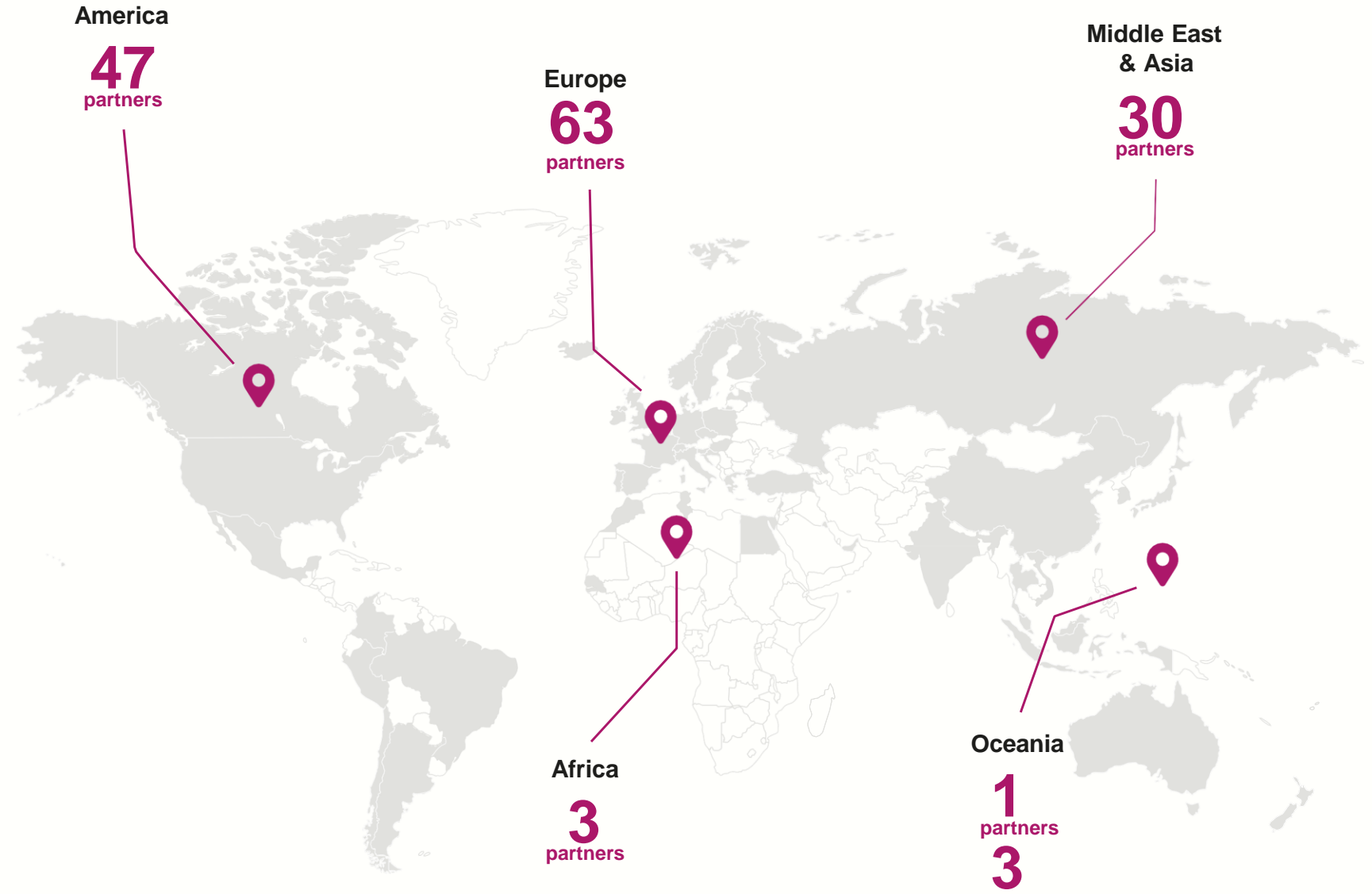

Powerful Connections with Companies

2,000

internships signed every year

3,000

partner companies



02

Studying in Paris



Student Clubs and Associations



01 BDE (Bureau des Élèves)



02 BDJ (Bureau des Jeux)



03 BDM (Bureau des Masters)



04 BDS (Bureau des Sports)



05 CheerWolf



06 GduCoeur



07 Jewish Student Association



08 Junior Enterprise

09 MEDIA



10 Music Industry

11 Oracy
12 PIA
(PSB International Association)

13 Start Hub



START HUB
PSB 2023 - 2024

Student Life in Paris



- More than 100 museums
- Free Museums for European Students under 26 years old
- Theaters and Comedy Shows



- Culture and arts
- Fashion (weeks)
- Unique Lifestyle
- Party HUB(s)
- Disneyland
- Traveling in France/Europe
- International City

Student Life in Paris



- From Luxury to Second Hand
- Fashion related events all year long



- Culture and arts
- **Fashion (weeks)**
- Unique Lifestyle
- Party HUB(s)
- Disneyland
- Traveling in France/Europe
- International City

Student Life in Paris



- Gastronomy
- “Tiers-Lieux” or how non-profit associations repurpose historical building/sites
- Transportation system



- Culture and arts
- Fashion (weeks)
- **Unique Lifestyle**
- Party HUB(s)
- Disneyland
- Traveling in France/Europe
- International City

Student Life in Paris



- Wide variety of clubs, from techno underground parties to high-end clubbing
- Festivals all year round
- Frequent Free Concerts



- Culture and arts
- Fashion (weeks)
- Unique Lifestyle
- **Party HUB(s)**
- Disneyland
- Traveling in France/Europe
- International City

Student Life in Paris



- Cheapest tickets in September and November
- Accessible using Public Transportation



- Culture and arts
- Fashion (weeks)
- Unique Lifestyle
- Party HUB(s)
- **Disneyland**
- Traveling in France/Europe
- International City

Student Life in Paris

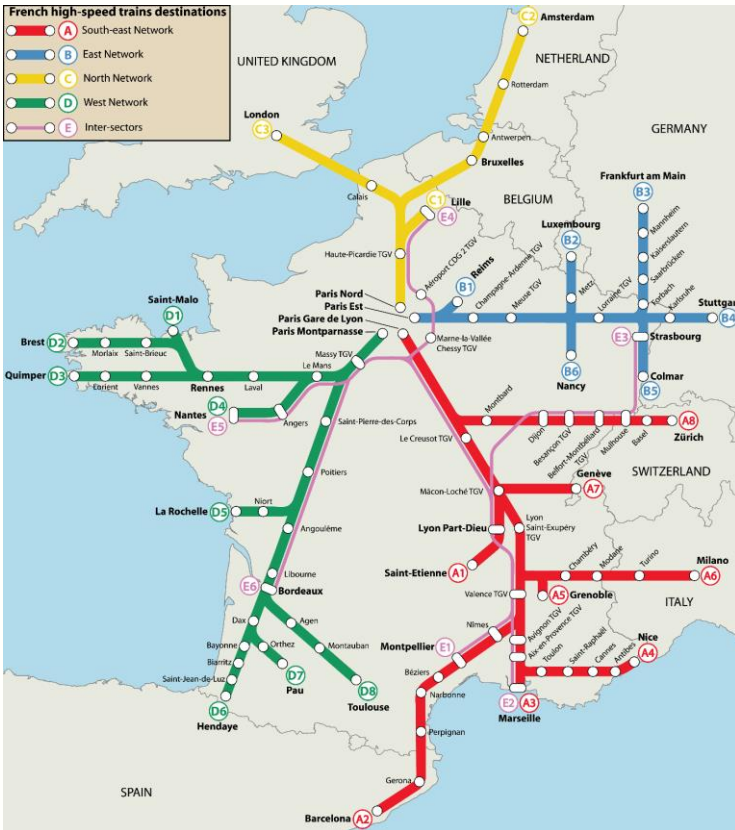

- CDG Airport connected to all major European Airports
- London, Amsterdam, Bruxelles, Cannes etc are accessible by train/bus
- Bus tickets affordable for weekend trips few hours away from Paris



- Culture and arts
- Fashion (weeks)
- Unique Lifestyle
- Party HUB(s)
- Disneyland
- Traveling in France/Europe
- International City

Student Life in Paris



- Huge Erasmus Community
- International Cultural Centers
- Biggest Expat Community in France with many networking events



- Culture and arts
- Fashion (weeks)
- Unique Lifestyle
- Party HUB(s)
- Disneyland
- Traveling in France/Europe
- **International City**

Paris Student Cost of Living

1,060 – 1760€ per month

Nature	Average Cost
Accommodation	600€ - 1,200€
Food	200 – 300€
Transportation	60 € (365€ /year)
Leisure	200€

Housing options: PSB Accomodation Guide



Transportation in Paris

The main mean of transportation in Paris is the metro

- Check the **RATP** (Public Transportation Network in Paris Region) travelers' guide to help you get familiar with the transportation system.

[Click here to see the Travelers' Guide](#)

- You may use the "Bonjour RATP" App to recharge your passes on your phone directly or go to the monitors inside the stations to buy your passes directly.
- Apps such as Google Maps, IDF Mobilité, Bonjour RATP, Citymapper etc, will help you find the best way for you to move around Paris from point A to point B.

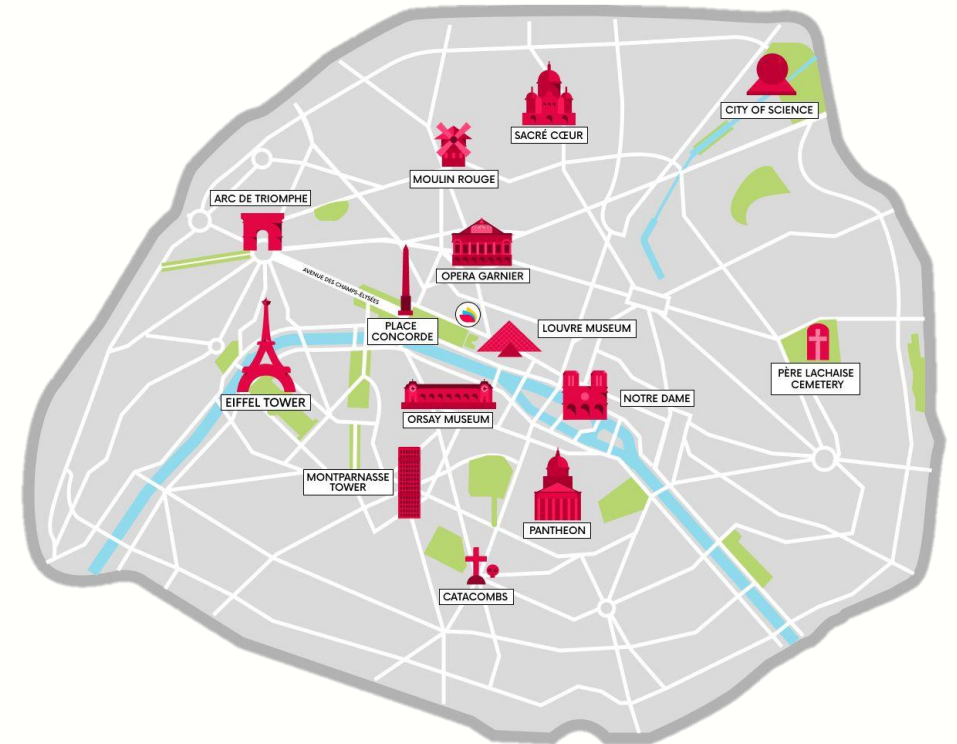

The new Claude Bernard campus

Opening of the new campus in the 5th district for the 2025-2026 academic year

Where 4500 students from five Galileo Global Education will cross paths:



A new campus

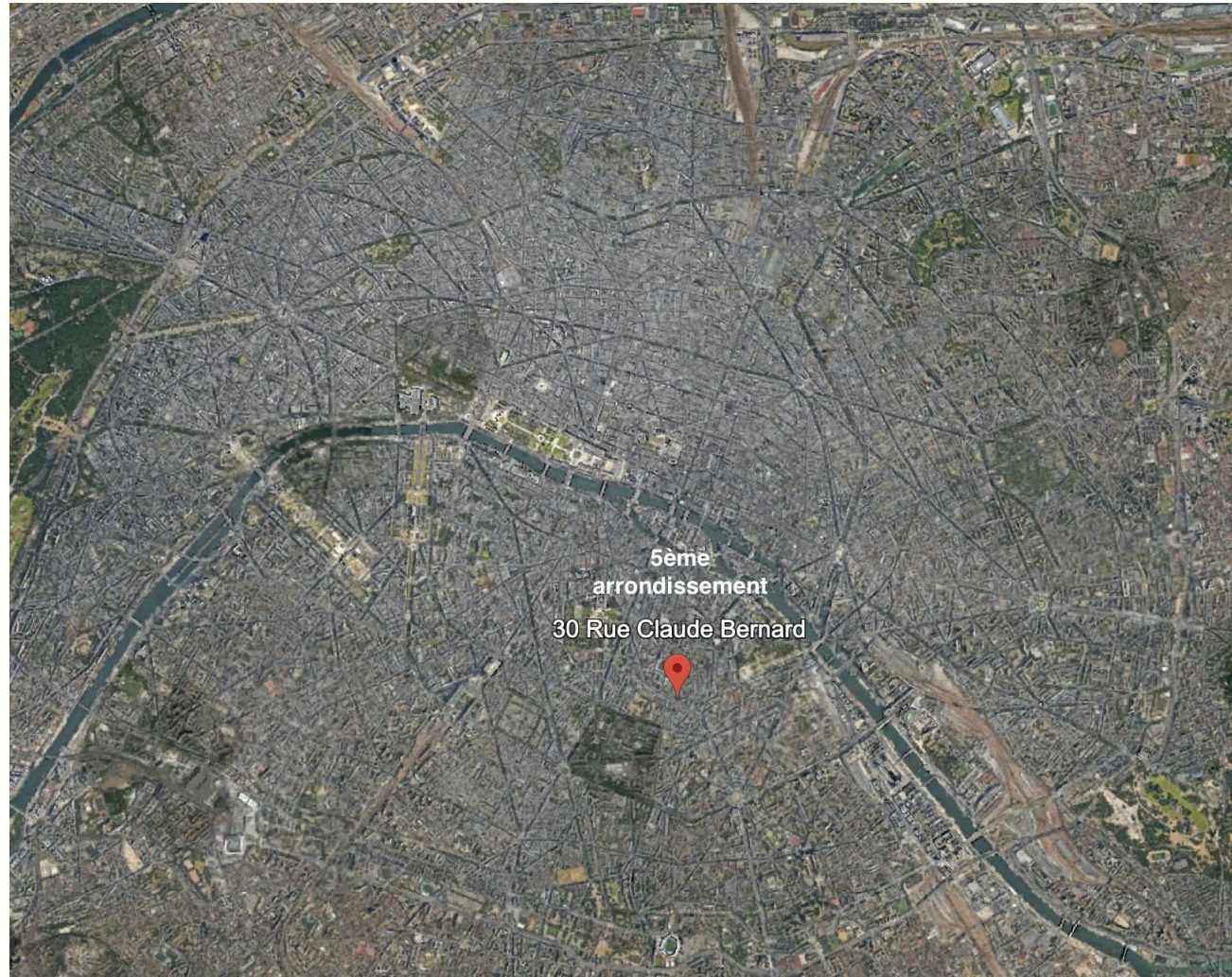

A new campus



A new campus

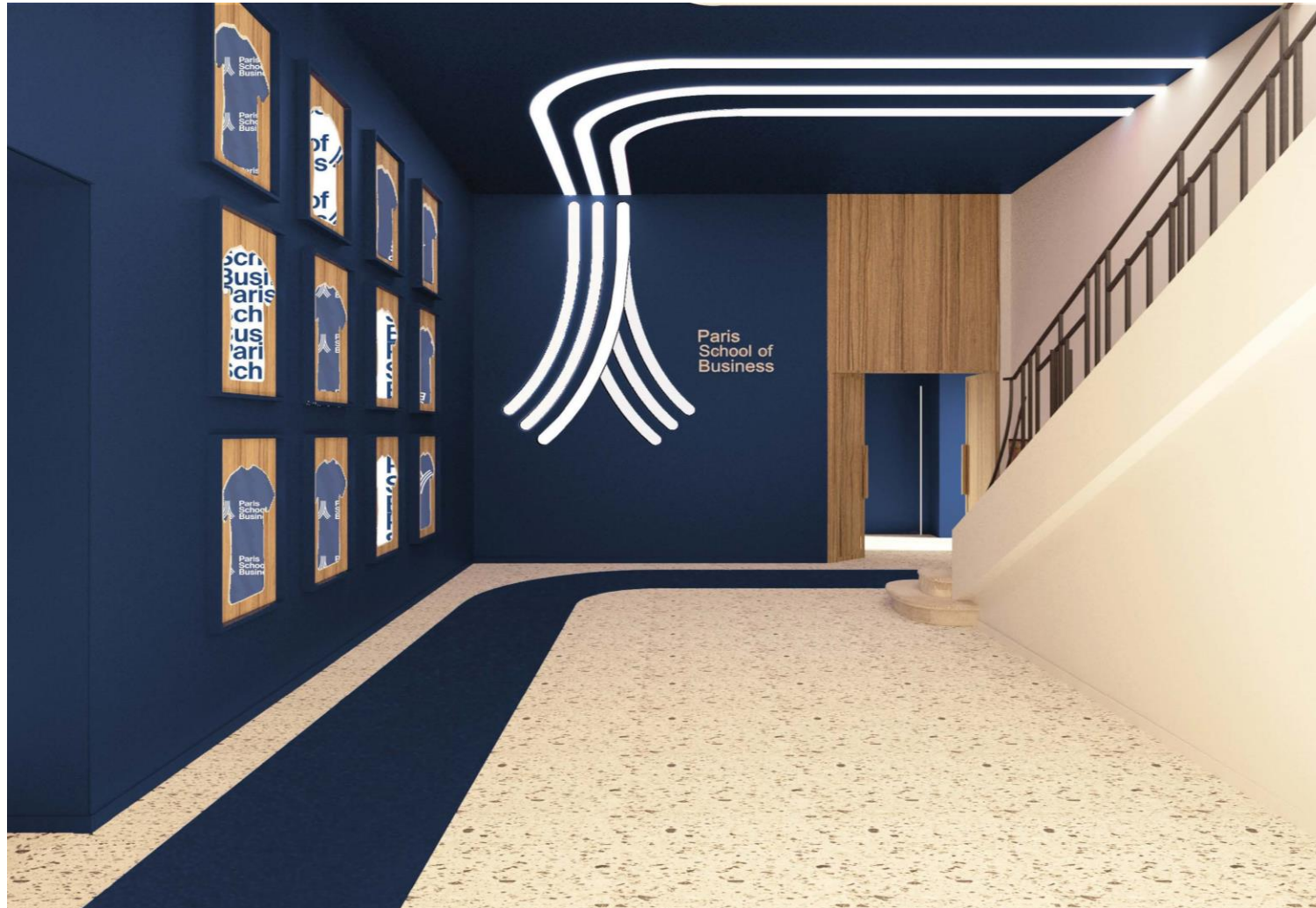

A new campus



A new campus



A new campus



A new campus



A new campus



Support System

Buddy System : <https://buddysystem.eu/fr/>

- Would you like someone to help you (documents, accommodations, jobs)?
- Would you enjoy discovering the local culture and practice a new language?
- Would you like to meet local students?



Buddy System

With the Buddy System, you will be paired with a Buddy to help you and share their experience of this new city!

Visit the places on your bucket list...





03

Our Study Abroad Programs

Study Abroad Track

The track is designed to give a **broad knowledge of business** but also to develop the student's practical, managerial & communication skills as well as business decision-making capability and **specialize in International Management, International Business or Luxury Brand Management.**

This program is considered as an undergraduate program.

Teaching Language



English

Mode of Study



Full Time

UNDERGRADUATE
STUDENTS

Length of Program



1 or 2 semesters

Academic
Requirements



Students need to have
studied in
business/economics field
for at least one year

Intake(s)



Fall and Spring

Study Abroad Track

Courses in English – Undergraduate level (Fall 2024)

Course Code	Track	Module	ECTS
SALUX001	PSB SA	Luxury Brand Management	6
SALUX002	PSB SA	Luxury Retail	6
SALUX003	PSB SA	Marketing applied to Luxury	6
SAMNT001	PSB SA	Management of Change and Innovation	6
SAMNT002	PSB SA	Principles of Operations Management	6
SAMNT003	PSB SA	Business consulting	6
SAMNT004	PSB SA	International Strategic Management	6
SAMNT005	PSB SA	Organizational Behavior	6
S4MNT062	PSB SA	Intercultural Communication	6
S4MNT063	PSB SA	Doing Business in Europe	6
S4IBE026	PSB SA	International Business	6
SAMKG001	PSB SA	International Marketing	6
SAFIN001	PSB SA	Corporate Finance	6
SAFIN002	PSB SA	International Finance	6
SAFRA001	PSB SA	French Beginner	6

Master in Management Track

The Master in Management program is the **flagship degree** of Paris School of Business.

It lasts 5 years and consists of a 3 years' undergraduate cycle, completed by a 2 years' postgraduate cycle.

Program available for students in undergraduate or postgraduate programs (years 1, 2, 3 or 4 of the MIM program).

Teaching Language



English or French

Mode of Study



Full Time

UNDERGRADUATE
&
POSTGRADUATE
STUDENTS

Length of Program



1 or 2 semesters

Min. Academic
Requirements



Students need to have
graduated in
business/economics
field

Intake(s)



Fall and Spring

Master in Management Track

English Courses – Postgraduate level (Fall 2024)

Course Code	Track	Module	ECTS
P4IBE008	PSB MIM M1 IT	Global Strategy Expansion & Business Transformation	6
P4ECO013	PSB MIM M1 IT	Contemporary Economic Issues	6
P4MNT148	PSB MIM M1 IT	Management & Leadership	6
P4FIN002	PSB MIM M1 IT	Finance For Manager	6
P4MKG011	PSB MIM M1 IT	Marketing Management: Integrated Communication	6

Courses & credits

Each course = 6 ECTS

2 programs: English or French

→ We will send course catalogues upon request by email. You cannot mix courses from different programs.

1 Orientation Day

For Fall 2024: September 12th, 2024

Fall 2024 :

12/09/2024 – 14/12/2024

04

Short Programs : Summer & Winter Schools



The Summer and Winter Schools enable international students to discover and acquire skills in two key areas: Luxury Brand Management and Artificial Intelligence for Business

50hrs

of classes, workshops &
cultural activities

100 %

in English

An international experience
that stands out on a CV

Equivalent to

7.5 ECTS

Short Programs Admissions



Short Programs Admissions

For more information

Program Includes

- Integration events
- Daily lectures and workshops
- Cultural visits (château de Versailles, Bateaux Mouches, Museums, etc..)

Practical information

- Fees €2950*
- Includes academics, accommodation, half board and activities
- Contact us at international@psbedu.paris

* *A discount of 300 euros is applied for students coming from partner universities.*

International Office (PSB IO)



Simon CHARRIER
Head of International
Office

T — +33 (0)1 53 36 44 35
s.charrier@psbedu.paris



Matthieu BUISSON
International Relations
Coordinator

T — +33 (0)1 55 23 95 88
m.buisson1@psbedu.paris

Merci.

Paris School of Business
59 rue nationale
75013 — Paris

+33 (0)1 84 60 27 04
www.psb.edu.paris

